

HIW/17/19

West Devon Highways and Traffic Orders Committee  
16 March 2017

## **Annual Local Waiting Restriction Programme**

Report of the Chief Officer for Highways, Infrastructure Development and Waste

***Please note that the following recommendations are subject to consideration and determination by the Committee before taking effect.***

**Recommendation: It is recommended that:**

- (a) work on the annual waiting restrictions programme and the prioritisation process applied in 16/17 is noted;***
- (b) the recommendations contained in Section 4. of this report are agreed and the proposals implemented where relevant;***
- (c) pending Cabinet support, and decisions on funding and scope of works; a further programme is developed for 17/18.***

### **1. Background**

The County Council regularly receives requests for waiting restrictions to be introduced or amended. These can be difficult to deliver due to resource and funding pressures which, in turn, can have a negative impact on the County Council's relationship with local communities.

Recognising this difficulty, a managed process has been developed to deliver an annual local programme for each HATOC area for the funding and delivery of waiting restriction schemes.

The agreed process was reported to Members at the March 2016 meeting along with the proposed programme for this Committee's area for approval.

Building on the success of this process, officers propose that a further programme is developed for 2017/18.

### **2. Proposal**

Pending Cabinet support, decisions on funding and scope of works, officers propose that:

- (a) the sites that have received objections in the 2016/17 programme are reported to this committee and decided individually, in line with the recommendations in Section 4.**
- (b) consideration is given to extending the scope of the programme in 2017/18 to include other restrictions and minor aids to movement improvements such as dropped crossing points.**

In preparation for the 17/18 programme, and assuming Cabinet support, Members may wish to discuss sites for consideration with local officers in the Neighbourhood Highways Teams.

### 3. Consultations

The 2016/17 Programme advertised proposals from Exeter City and all District Council Areas. A budget of £100,000 was allocated to the project with indicative budgets of £12,500 for each area. The number of requests received in some areas significantly exceeded others but have all been contained within the overall budget.

The table below shows the number of proposals advertised in each area, the number of sites progressed without significant objection, the number of sites to be reported to HATOC in each area and the number of objections received respectively.

Area	Available Funding	No. of Sites advertised	No. of Sites Progressed	No. of Sites to be reported to HATOC	No. of Objections received
Torrige	£12,500	8	6	2	1
Mid Devon	£12,500	10	9	1	5
East Devon	£12,500	58	21	37	49
West Devon	£12,500	14	8	6	39
South Hams	£12,500	54	32	22	71
Exeter	£12,500	81	58	23	43
Teignbridge	£12,500	34	20	14	28
North Devon	£12,500	22	14	8	8
<b>Total</b>	<b>£100,000</b>	<b>282</b>	<b>168</b>	<b>114</b>	<b>247</b>

### 4. Representations Received in the West Devon area

Objections have been received to the following proposals

#### Summary of Representations

Comments	Devon County Council (DCC) Response
<b>Bere Alston, Fore Street (Plan ENV5558-1(A))</b>	
<b>14 objections (8 residents of Fore Street and 6 Residents of wider Bere Alston area)</b>	
<p>8 objectors concerned that vehicle speeds will increase if parking is removed.</p> <p>2 objectors concerned of increased risk to pedestrian or other road users.</p> <p>5 objectors concerned about loss of trade to local shops and businesses.</p> <p>6 objectors concerned about displaced parking will create more of a problem in the village. Or where will they park?</p> <p>2 objectors reported that there was not a problem and that the Parish Council, local fire officer and snow warden agreed with this statement.</p>	<p><b>Reason for the Proposal</b></p> <p>To prevent obstructive parking on Fore Street. Larger vehicles including Council Gritters have been prevented from using the road. There is also evidence of vehicle strikes on the corner of the Bere Alston United Church building.</p> <p>No speed data is available for Bere Alston. However this is a narrow road in a low speed village environment and removal of a pinch point would not usually be regarded as creating a safety hazard.</p> <p>The proposal would have no effect on the footway availability and would also improve inter-visibility between Pedestrians and Motorists.</p>

Comments	Devon County Council (DCC) Response
<p>3 objectors mention impact on Methodist Church and the elderly visiting the church.</p> <p>2 objectors concerned about loading and unloading.</p> <p>Vehicle Activated Sign (VAS) be located in Fore Street to light if driver exceeds posted speed limit.</p> <p>Make Fore Street one-way.</p> <p>Relocate bus stop outside Edgecombe Hotel.</p>	<p>The loss of parking proposed is approximately 3 spaces which are currently only available in the evening. The proposals do not affect the available parking stock during trading hours or the availability of loading and unloading.</p> <p>DCC do not erect VAS unless there is evidence of a speed issue.</p> <p>Making a street one-way may increase vehicle speeds and is outside of the scope of this consultation.</p> <p>Relocation of the Bus Stop is outside the scope of this consultation but might be considered in a future review.</p>
<p><b>RECOMMENDATION – To arrange site meeting with County Councillor, HATOC Chair and Parish Council to agree a resolution of the proposals.</b></p>	
<p><b>Buckland Monachorum, Yelverton (Plan ENV5558-8(A) Rev1)</b></p>	
<p><b>Two partial objections &amp; one supporter</b></p>	
<p><b>Objection 1</b></p> <p>(Buckland Monachorum Parish Council)</p> <p>Agreed to all proposals except for those in Harrowbeer Lane and Westella Road. The Parish Council (PC) wanted it understood that the lack of parking around Yelverton forecourt is already a subject of concern and would not wish this proposal to make matters worse. No safety concerns have been noted by the PC in either of these locations. The PC would therefore propose that the restrictions in:</p> <ul style="list-style-type: none"> <li>• Harrowbeer Lane be shortened from the proposed 25 and 30m to 10m both sides.</li> <li>• Westella Road proposal should not be progressed.</li> </ul> <p><b>Objection 2</b> (Resident of Milton Combe)</p> <ul style="list-style-type: none"> <li>• Harrowbeer Lane - can see no reason to restrict parking here at all.</li> <li>• Westella Road. Suggests that the restriction should be extended further as far as the Beauty Salon. Comments that this will displace parking to other roads in the area.</li> </ul>	<p><b>Harrowbeer Lane - Reason for the Proposal.</b></p> <p>Double Yellow Lines are proposed to prevent obstruction of the approach to the junction with the B3212 Dousland Road.</p> <p><b>Westella Road – Reason for the Proposal.</b></p> <p>Vehicles parked on this short section of Westella Road can obstruct the entrance to The Rock Inn.</p>

Comments	Devon County Council (DCC) Response
<p><b>Supporter 1 (Address unknown)</b></p> <ul style="list-style-type: none"> <li>Fully supports proposals for Dousland and Yelverton. Comments that the proposals seem sensible.</li> </ul>	
<p><b>RECOMMENDATION – To arrange site meeting with County Councillor, HATOC Chair and Parish Council to agree a resolution of the proposals.</b></p>	
<p><b>Horrabridge, Manor Estate (Plan ENV5558-5(A))</b></p>	
<p><b>3 Objections from residents of Horrabridge but not of Manor Estate 1 specific supporter, who is a resident of Manor Estate</b></p>	
<p><b>General Objections:</b></p> <ul style="list-style-type: none"> <li>All 3 objectors concerned at loss of parking as demand for parking spaces in the village already exceeds that available.</li> <li>1 objector is concerned that vehicle speeds will increase if parking is removed.</li> </ul> <p><b>Supporter 1 (Resident of Manor Estate)</b></p> <ul style="list-style-type: none"> <li>Good news but restrictions may exacerbate current parking obstructions down the estate and on the corner of Manor Gardens which inhibits vehicle free passage, turning the corner, deliveries and collections.</li> </ul> <p><b>Support 2 (Parish Council)</b></p> <ul style="list-style-type: none"> <li>Supports the Proposals. nb: This support came in after the advertising period had finished and is the PC's response after considering the objections received.</li> </ul>	<p><b>Reason for the Proposal.</b></p> <p>To prevent obstruction of the junction with A386 and to ensure access into the Manor Estate.</p> <p>This is a short 45m long feeder road into the Manor Estate. Inconsiderate parking along this section of road obstructs access for residents and deliveries. No speeding issues are anticipated as a result of the proposals being implemented.</p>
<p><b>RECOMMENDATION – To implement the restrictions on the Manor Estate as advertised.</b></p>	
<p><b>Horrabridge, Bedford Place and Jordon Lane Plan (ENV5558-4(A))</b></p>	
<p><b>(17 objections and 1 supporter)</b></p>	
<p><b>17 Objectors</b></p> <ul style="list-style-type: none"> <li>All objectors are concerned at loss of on street parking in an area that is already short of available spaces.</li> </ul> <p><b>Objection 2 (Parish Council)</b></p> <ul style="list-style-type: none"> <li>The lines proposed for Bedford Road and Jordan Lane are controversial. The PC requests that the proposal for these are deleted from the schedule. nb: This objection came in after the advertising period had finished and is the Parish</li> </ul>	<p><b>Reason for the Proposal</b></p> <p>The proposals seeks to prevent obstruction by parked vehicles at this junction.</p>

Comments	Devon County Council (DCC) Response
<p>Council's response after considering the large number of objections received to this element of the TRO.</p> <p><b>Supporter 1 (Resident Bedford Road)</b></p> <ul style="list-style-type: none"> <li>This will make it easier to get in and out of our drive.</li> <li>Prevent delivery lorries knocking on the door to find the owner of a vehicle preventing them making a delivery.</li> </ul>	
<p><b>RECOMMENDATION – That the proposals should not be implemented at this time.</b></p>	
<p><b>Horrabridge, Whitchurch Road (Plans ENV5558-7(A) &amp; ENV5558-6 (A))</b></p>	
<p><b>10 objections</b></p>	
<ul style="list-style-type: none"> <li>10 objectors concerned at loss of parking as demand for parking spaces already exceeds that available.</li> <li>6 objectors concerned that parking will be displaced elsewhere.</li> <li>1 objector has not witnessed the problem.</li> <li>2 objectors state that no help is being given in finding alternative parking.</li> <li>3 objectors are concerned that vehicle speeds will increase if parking is removed.</li> <li>1 Objector is concerned that the proposals might affect the value of nearby properties.</li> </ul> <p><b>Parish Council</b></p> <ul style="list-style-type: none"> <li>The Parish Council would like the advertised restriction on the south-west side of Whitchurch Road shortened from 15m to 12.5m leaving enough room for gritting lorries and buses to make the turn. The lines on the north-east side to be carried out as notified.</li> </ul>	<p><b>Reasons for the Proposals</b></p> <p>The proposals seeks to prevent obstruction by parked vehicles at junctions and on narrow sections of the road.</p>
<p><b>RECOMMENDATION – To arrange site meeting with County Councillor, HATOC Chair and Parish Council to agree a resolution of the proposals</b></p>	
<p><b>Tavistock, Chollacott Lane. (Plan ENV5558-10(A))</b></p>	
<p><b>One Objection</b></p> <p>Objecting because vehicles will be displaced from junction with Whitchurch Road in Chollacott Lane. These displaced vehicles will likely obstruct access to narrow lane leading to the objector's property.</p>	<p><b>Reason for the Proposal</b></p> <p>The proposals seeks to prevent obstruction by parked vehicles at this junction. The road is narrow and parking in this location will potentially block the road.</p> <p>Further restrictions can be advertised as part</p>

Comments	Devon County Council (DCC) Response
Suggests that Double Yellow Lines at the junction are postponed until such a time that restrictions can be advertised at junction of narrow lane lading to the property.	of the 2017/18 Hatoc Waiting Restriction Review if the concerns of the objector are realised.
<b>RECOMMENDATION – To implement the restrictions on the Chollacot Lane as advertised.</b>	

Plans of the proposals referred to above can be seen in Appendix A to this report.

## 5. Financial Considerations

The total costs of the scheme are contained within a countywide budget of £100,000 which has been allocated from the On Street Parking Account.

## 6. Environmental Impact Considerations

The scheme rationalises on street parking within the town and its stated objectives are designed to:

- Enable enforcement to be undertaken efficiently.
- Encourage longer term visitors to use off street car parks.
- Encourage those working in the town make more sustainable travel choices eg Car Share, Public Transport, Walking and Cycling.

The Environmental effects of the scheme are therefore positive.

## 7. Equality Considerations

There are not considered to be any equality issues associated with the proposals. The impact will therefore be neutral.

## 8. Legal Considerations

The lawful implications and consequences of the proposal have been considered and taken into account in the preparation of this report.

When making a Traffic Regulation Order it is the County Council's responsibility to ensure that all relevant legislation is complied with. This includes Section 122 of the Road Traffic Regulation Act 1984 that states that it is the duty of a local authority, so far as practicable, secures the expeditious, convenient and safe movement of traffic and provision of parking facilities. It is considered that the proposals comply with Section 122 of the Act as they practically secure the safe and expeditious movement of traffic in the West Devon area.

## 9. Risk Management Considerations

There are thought to be no major safety issues arising from the proposal.

## 10. Public Health Impact

There is not considered to be any public health impact.

## 11. Reasons for Recommendations

The proposals rationalise existing parking arrangements within the West Devon Area:

- Enabling enforcement to be undertaken efficiently.
- Encouraging longer term visitors to use off street car parks.
- Encouraging commuters to make more sustainable travel choices eg Car Share, Public Transport, Walking and Cycling.

The proposals contribute to the safe and expeditious movement of traffic in the West Devon Area and therefore comply with S 122 of the Road Traffic Regulation Act 1984.

David Whitton  
Chief Officer for Highways, Infrastructure Development and Waste

### **Electoral Divisions: All in West Devon**

Local Government Act 1972: List of Background Papers

Contact for enquiries: Mike Jones

Room No: ABG Lucombe House

Tel No: 01392 3830000

Background Paper	Date	File Ref.
None		

mj010317wdh  
sc/cr/annual local waiting restriction programme  
02 080317

Appendix A  
To HIW/17/19

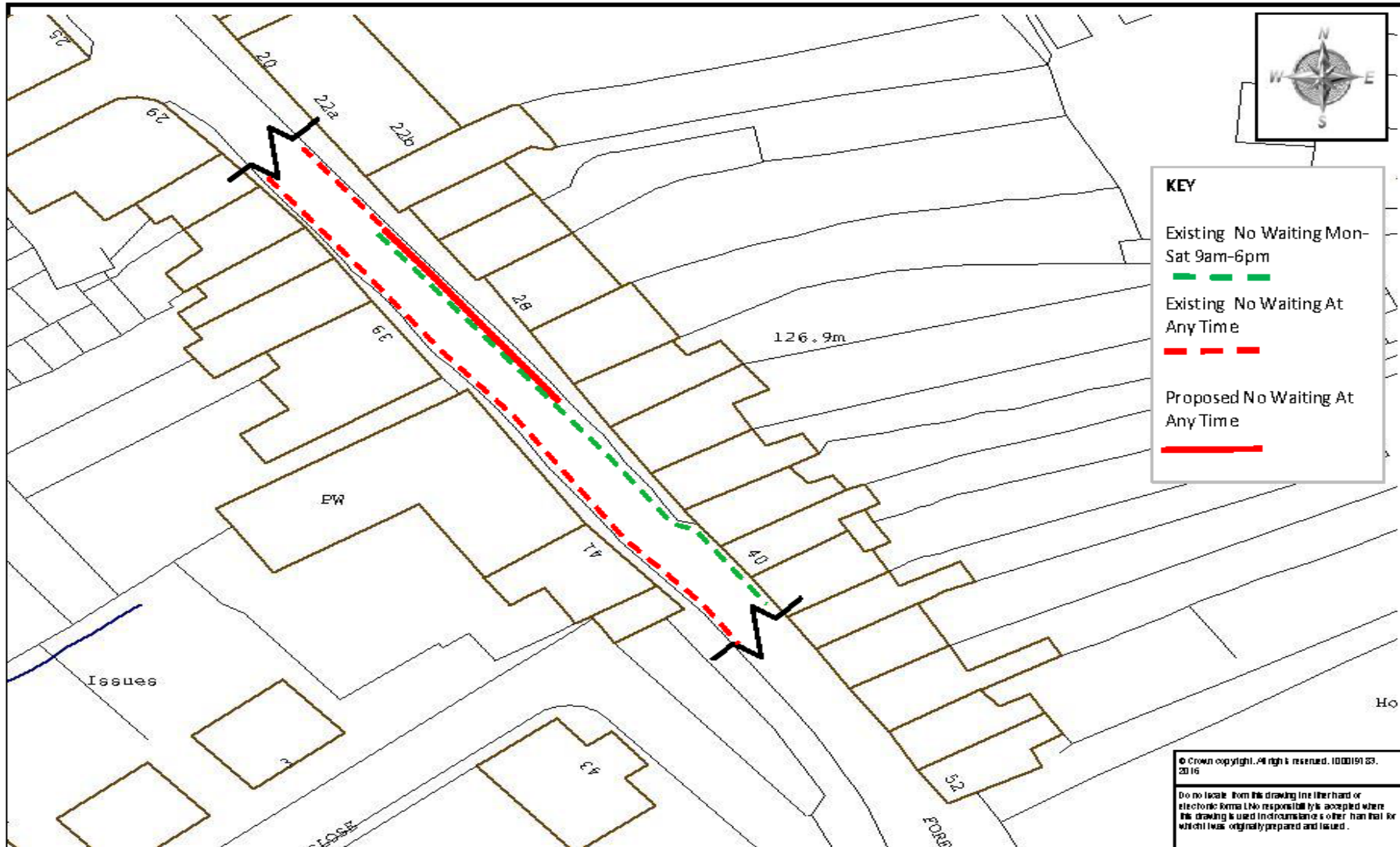

**KEY**

Existing No Waiting Mon-Sat 9am-6pm  

Existing No Waiting At Any Time  

Proposed No Waiting At Any Time  

© Crown copyright. All rights reserved. 100019133, 2016

Do not scale from this drawing line (either hard or electronic forms) the responsibility is accepted where this drawing is used in circumstances other than that for which it was originally prepared and issued.



David Wilson  
Head of Capital Development,  
Highways & Waste

MANAGEMENT TEAM  
DEVON HOUSE  
LEONARD HOUSE  
COUNTY HALL  
EX1 1SR  
03453  
WATER 0345 55 554

SCHEME  
BERE ALSTON, FORE STREET

DRAWING  
PROPOSED NO WAITING AT ANY TIME

drawn by	scale
TL	NTS
date	O.S Ref
09-Aug-2016	244798,66702
drawing number	
EN V5558-1(A)	



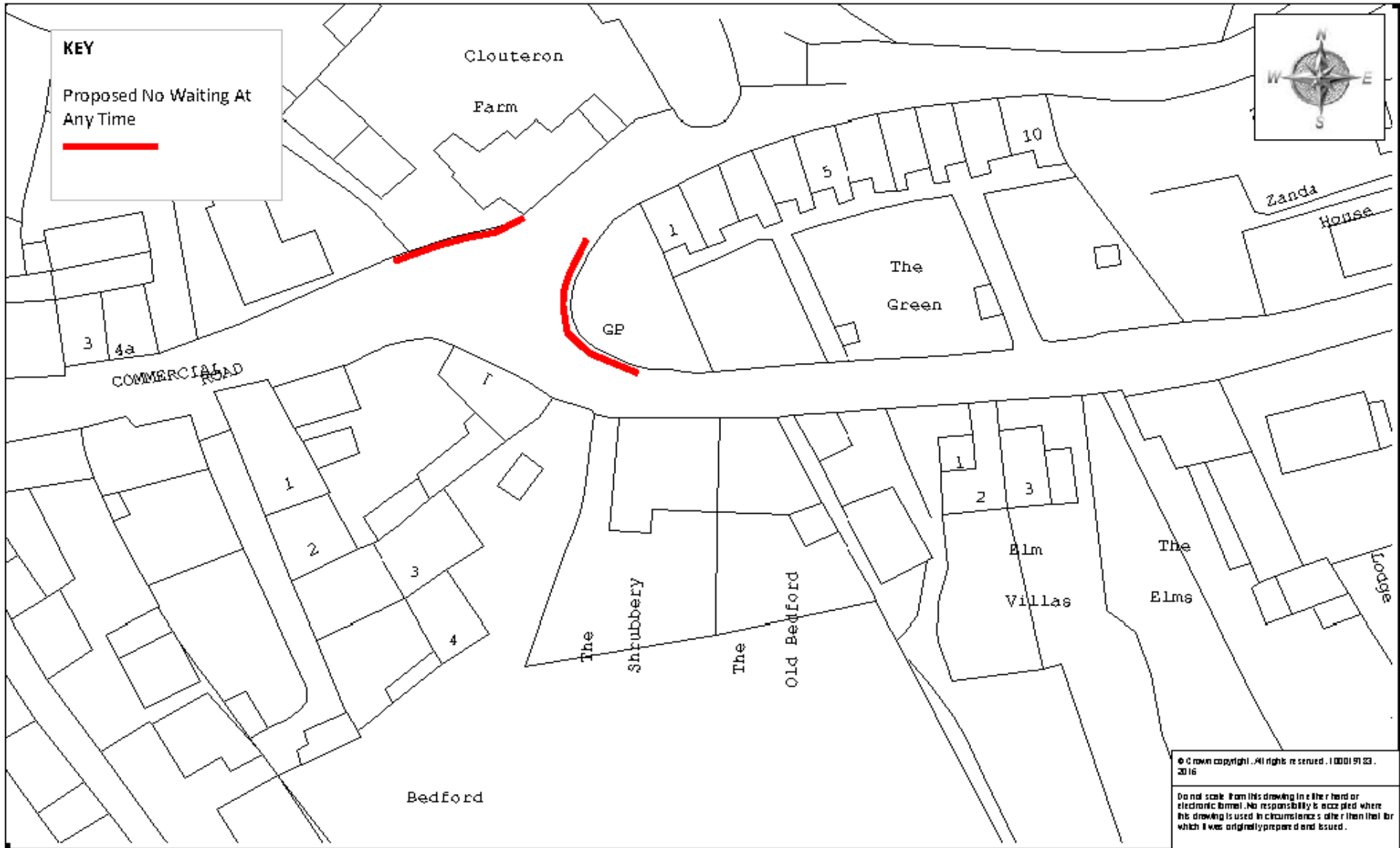

**KEY**  
 Proposed No Waiting At Any Time  



© Crown copyright. All rights reserved. 1 0001 91 03. 2016

Do not scale from this drawing in either hard or electronic format. No responsibility is accepted where this drawing is used in circumstances other than that for which it was originally prepared and issued.



David Wilson  
 Head of Capital Development,  
 Highways & Waste  
 TRAFFIC ENGINEERING TEAM  
 DESIGN HIGHWAYS  
 LICENCE HOUSE  
 COUNTY HALL  
 EXETER  
 EX2 000  
 Telephone 01392 66 100

**SCHEME**  
 HORRABRIDGE  
 BEDFORD ROAD/JORDAN LANE AND COMMERCIAL ROAD

**DRAWING**  
 PROPOSED NO WAITING AT ANY TIME

<b>Drawn by</b>	<b>Scale</b>
AJG	NTS

<b>Date</b>	<b>O.S. Ref</b>
19-May-2016	251433,69947

**Drawing number**  
 ENV5558-4(A)



**KEY**

Existing Bus Stop  
Clearway  

Proposed No Waiting At  
Any Time  

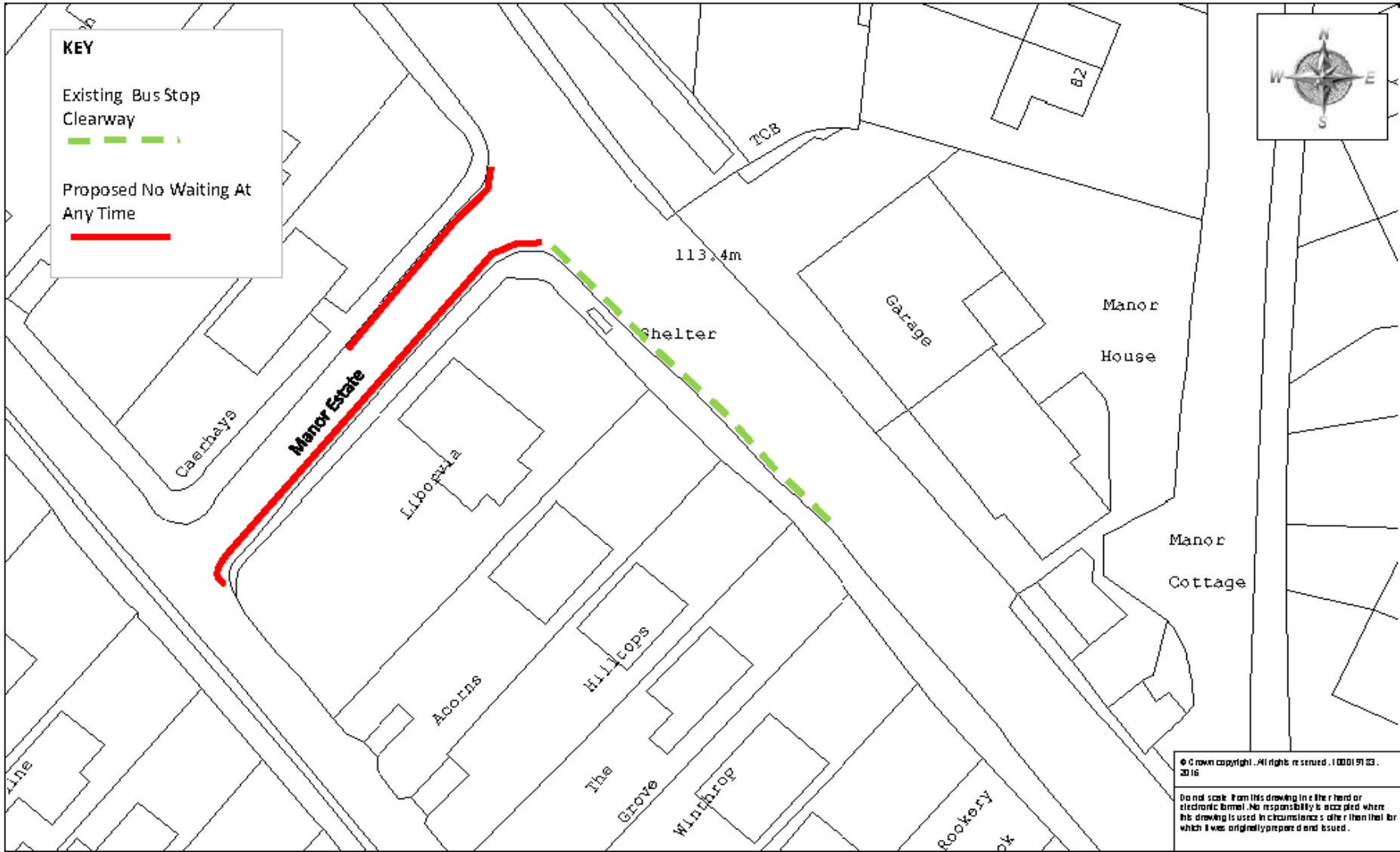

© Crown copyright. All rights reserved. 100019103.  
2016

Do not scale from this drawing in either hard or electronic format. No responsibility is accepted where this drawing is used in circumstances other than that for which it was originally prepared and issued.



David Wilson  
Head of Capital Development,  
Highways & Waste

TRAFFIC MANAGEMENT TEAM  
DEVON HIGHWAYS  
LUDLOW HOUSE  
COUNTY HALL  
EXETER  
EX4 1DD  
Telephone 01392 661564

SCHEME	HORRABRIDGE - MANOR ESTATE	
DRAWING	PROPOSED NO WAITING AT ANY TIME	

drawn by	scale
AJG	NTS
date	O/S Ref
19-May-2016	251119,69563
drawing number	
ENV5558-5(A)	

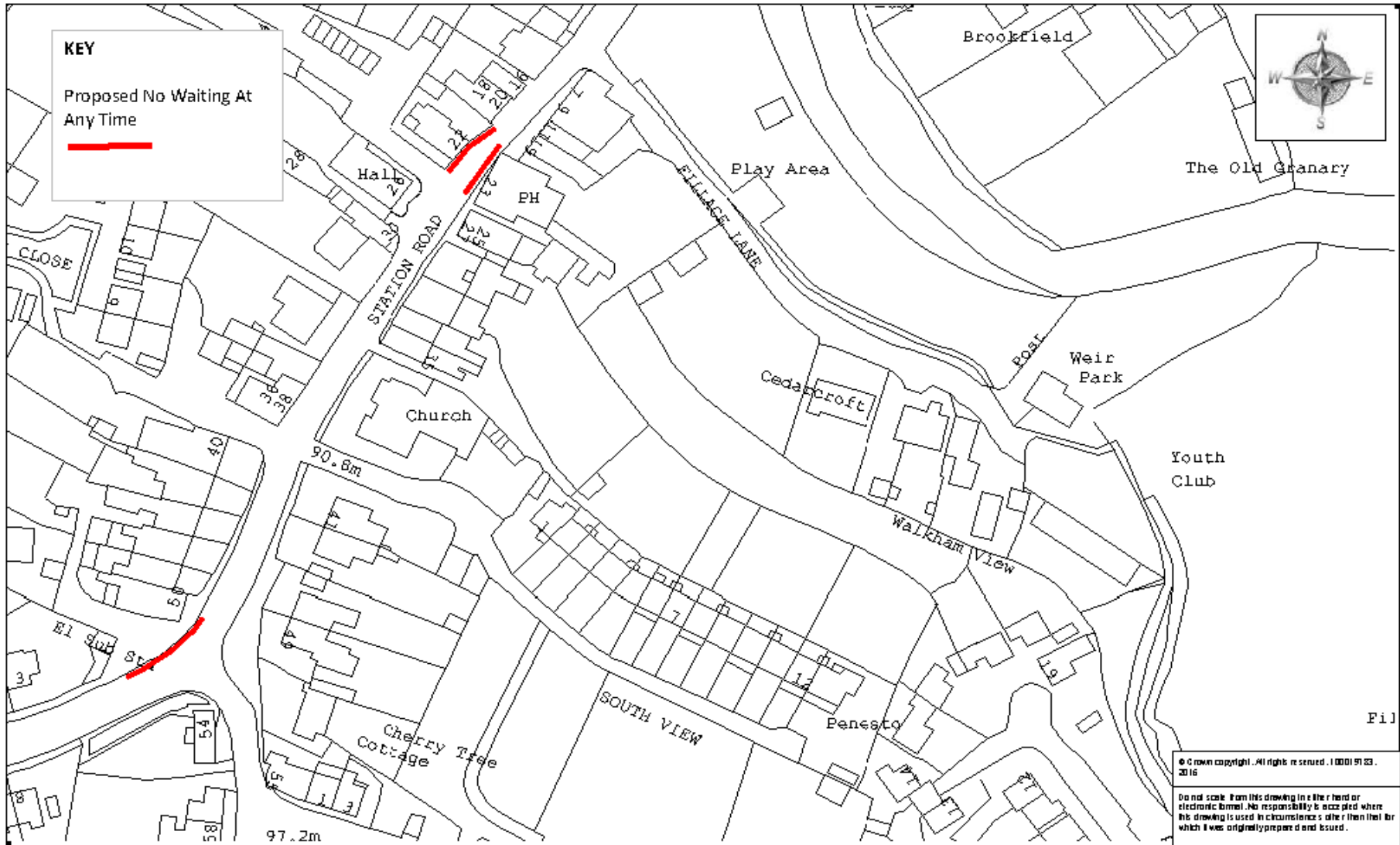

Fl 1

© Crown copyright. All rights reserved. 100019123. 2016

Do not scale from this drawing in either hard or electronic format. No responsibility is accepted where this drawing is used in circumstances other than that for which it was originally prepared and issued.

David Wilson  
Head of Capital Development,  
Highways & Waste

TRAFFIC MANAGEMENT TEAM  
SECTION MANAGERS  
LUCAS HOUSE  
COUNTY HALL  
EXETER  
EX2 0DG  
Telephone 01392 661000

**SCHEME**  
HORRBRIDGE - STATION ROAD

**DRAWING**  
PROPOSED NO WAITING AT ANY TIME

<b>Drawn by</b> TL	<b>Scale</b> NTS
<b>Date</b> 09-Aug-2016	<b>D.S. Ref</b> 251221,69778
<b>Drawing number</b> ENV5558-6(A)	

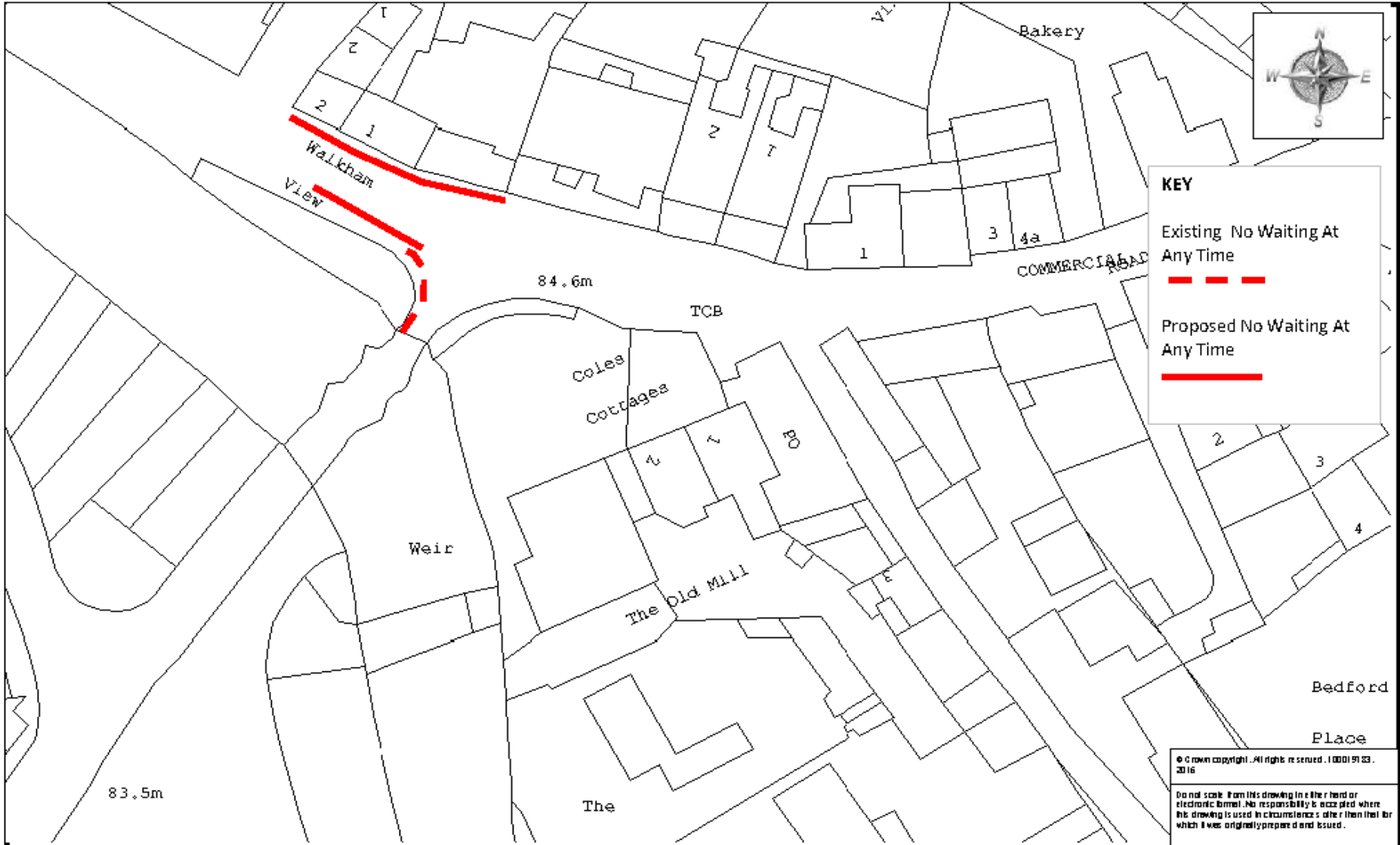

**KEY**

Existing No Waiting At Any Time  
 - - - - -

Proposed No Waiting At Any Time  
 \_\_\_\_\_

© Crown copyright. All rights reserved. 100019133. 2016

Do not scale from this drawing in either hard or electronic format. No responsibility is accepted where this drawing is used in circumstances other than that for which it was originally prepared and issued.

Drawn by	Scale
AJG	NTS

Date	D.S. Ref
19-May-2016	251335,69933

Drawing number  
**ENV5558-7(A)**



David Wilson  
 Head of Capital Development,  
 Highways & Waste

TRAFFIC MANAGEMENT TEAM  
 DEVON HIGHWAYS  
 LUCY HUGHES  
 COUNTY HALL  
 EXETER  
 EX2 000  
 Telephone 01392 661000

SCHEME

HORRABRIDGE  
 WHITCHURCH ROAD AT JUNCTION OF STATION ROAD

DRAWING

PROPOSED EXTENSION AND NEW NO WAITING AT ANY TIME

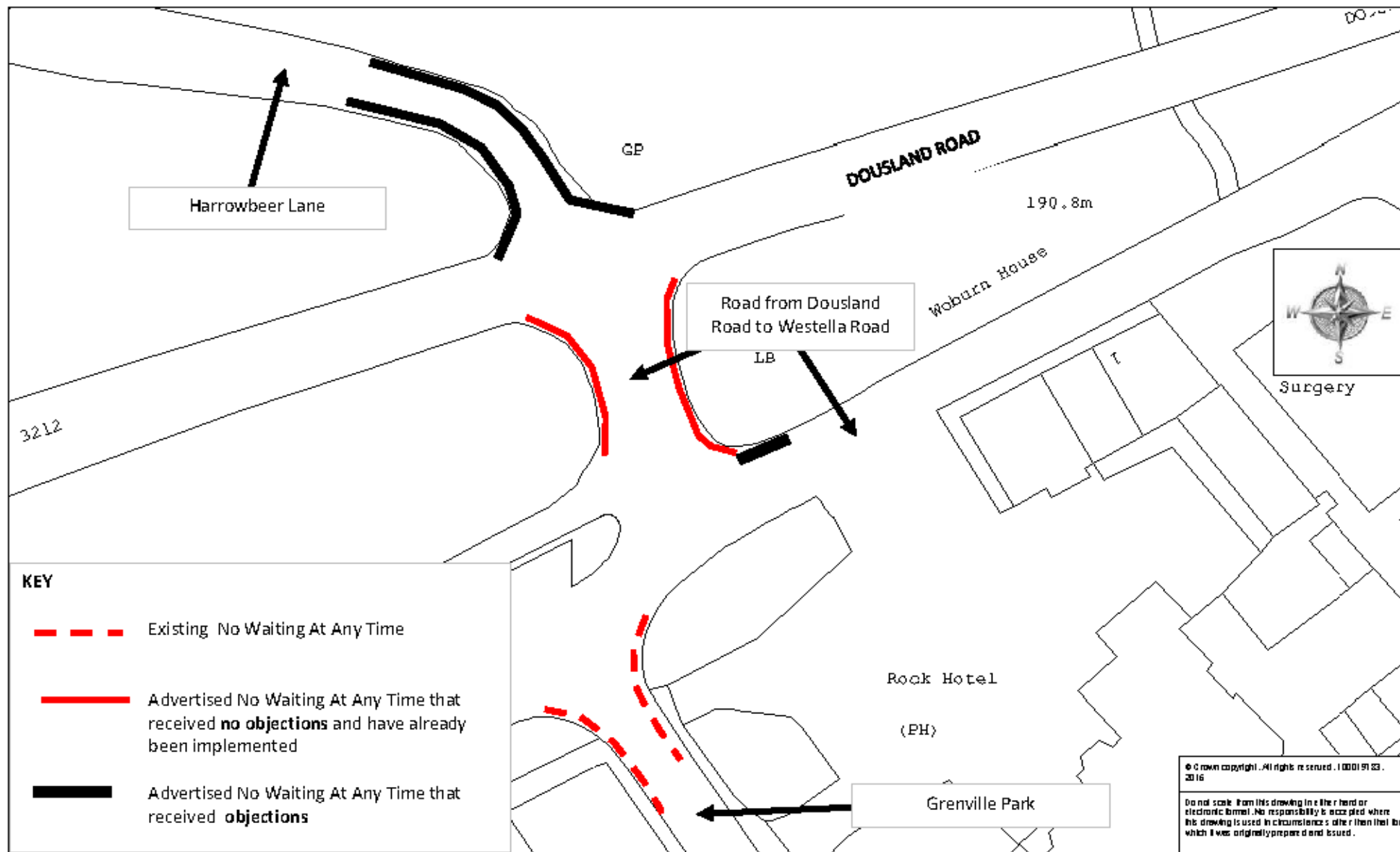

- KEY**
- - - - - Existing No Waiting At Any Time
  - Advertised No Waiting At Any Time that received **no objections** and have already been implemented
  - Advertised No Waiting At Any Time that received **objections**

© Crown copyright. All rights reserved. 100019153, 2016

Do not scale from this drawing in either hard or electronic format. No responsibility is accepted where this drawing is used in circumstances other than that for which it was originally prepared and issued.

David Wilson  
Head of Capital Development,  
Highways & Waste

TRAFFIC ENGINEERING TEAM  
DEVON HOUSE  
DEVON COUNTY COUNCIL  
COUNTY HALL  
EXETER  
EX2 0DG  
Telephone 01392 661000

SCHEME  
YELVERTON  
HARROWBEER LANE & ROAD FROM DOUSLAND ROAD TO WESTELLA ROAD

DESCRIPTION  
PROPOSED NO WAITING AT ANY TIME

Drawn by TL	Scale NTS
----------------	--------------

Date 09-Aug-2016	O/S Ref 252208,67898
---------------------	-------------------------

Drawing number  
**ENV5558-8(A) Rev1**

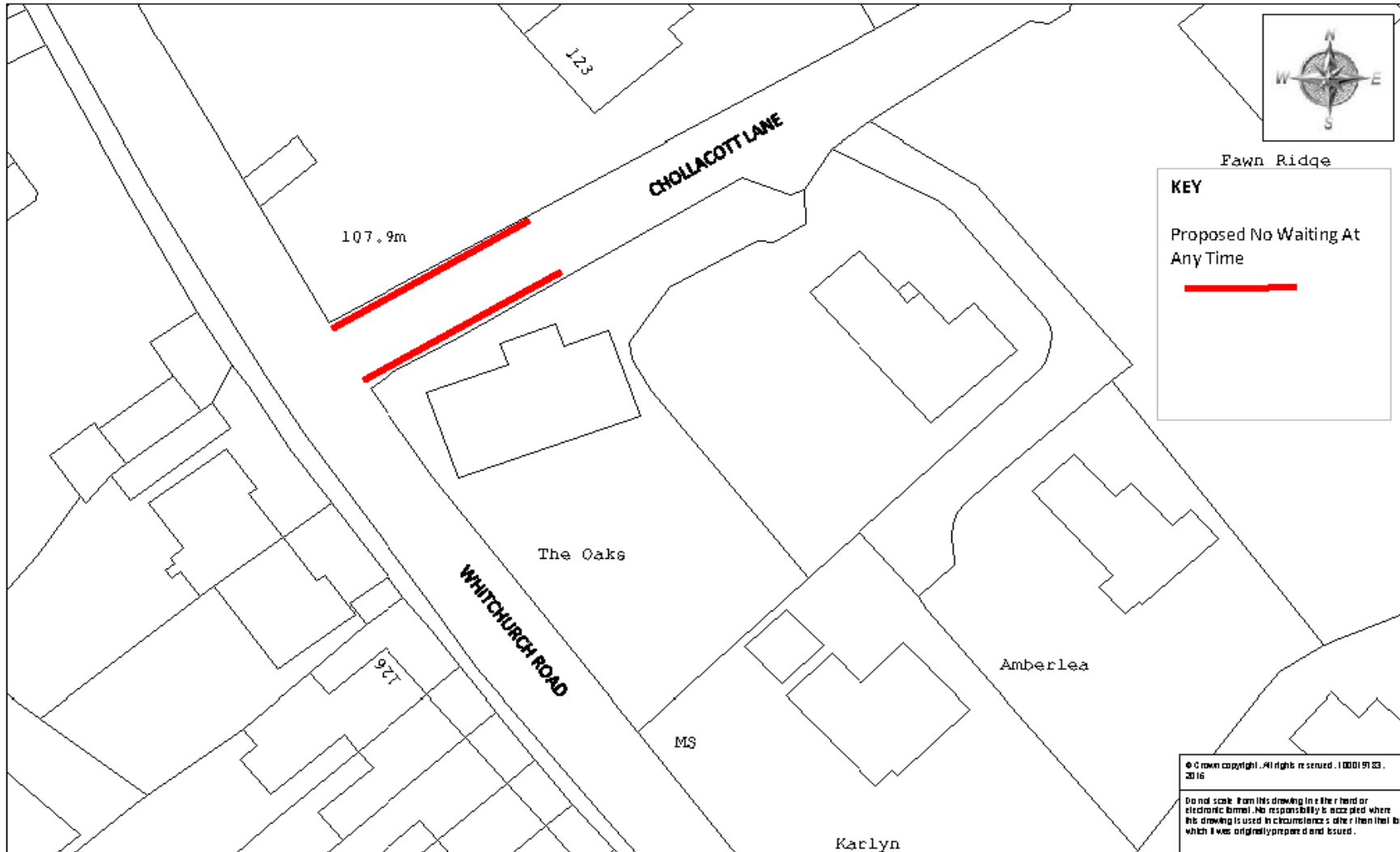

Fawn Ridge

**KEY**

Proposed No Waiting At Any Time

© Crown copyright. All rights reserved. 100019133. 2016

Do not scale from this drawing in a file or electronic format. No responsibility is accepted where this drawing is used in circumstances other than that for which it was originally prepared and issued.

David Wilson  
Head of Capital Development,  
Highways & Waste

TRAFFIC AND HIGHWAYS TECH  
DEVON HIGHWAYS  
WITCHAMPS HOUSE  
COUNTY HALL  
EXETER  
EX2 0DG  
Telephone 01392 661000

SOURCE  
TAMSTOCK - CHOLLACOTT LANE

DRAWING  
PROPOSED NO WAITING AT ANY TIME

Drawn by	Scale
AJG	NTS
Date	O.S. Ref
20-May-2016	248498,73130
Drawing number	
ENV5558-10(A)	